

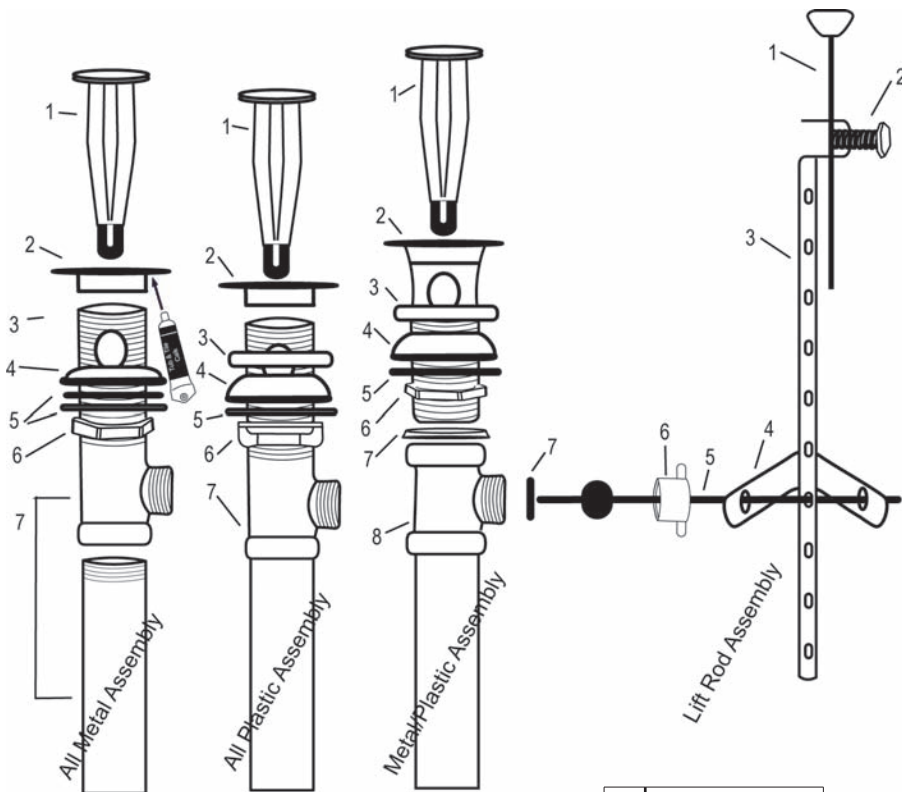

Making Water Work Beautifully

Pop-up Drain Installation Instructions



No.	NAME
1	DRAIN PLUG
2	DRAIN FLANGE
3	TUB & TILE CAULK (NOT INCLUDED)
4	COMPRESSION WASHER
5	FLAT WASHERS
6	METAL MOUNTING NUT
7	DRAIN TUBE ASSEMBLY

No.	NAME
1	DRAIN PLUG
2	DRAIN FLANGE
3	FLANGE SEAL
4	COMPRESSION WASHER
5	FLAT WASHER
6	PLASTIC MOUNTING NUT
7	DRAIN TUBE

No.	NAME
1	DRAIN PLUG
2	DRAIN FLANGE
3	FLANGE SEAL
4	COMPRESSION WASHER
5	FLAT WASHER
6	METAL MOUNTING NUT
7	DRAIN TUBE SEAL
8	DRAIN TUBE

No.	POP-UP ROD ASSEMBLY
1	UPPER LIFT ROD
2	HEX CAP SCREW
3	LOWER LIFT STRAP
4	CLIP
5	BALL ROD
6	BALL ROD NUT
7	ROD SEAL

All Metal Assembly

1. DISASSEMBLE DRAIN FLANGE

Separate the **drain flange** from the **drain tube assembly**. Leave the **mounting nut, washers and compression seal** (beveled edge facing up) on the **drain tube assembly**.

2. INSTALL DRAIN FLANGE & TUBE

Apply tub & tile caulk to the underside of the **drain flange**. From under the sink, slide the **drain tube assembly** through the drain hole in the sink. Screw the **drain flange** back onto the **drain tube assembly** and position it in the sink. Slide the **compression washer** up against the sink. Slide the **flat washers** up to the **compression washer**. Screw on the **mounting nut** but **DONOT TIGHTEN**. continue to step 3

3. INSTALL DRAIN PLUG

Rotate the **drain tube** until the opening on the side is facing you. Insert the **drain plug** and align the hole at the bottom with the hole in the side of the **drain tube** in one of the following ways:

To lock the plug down when the lift rod is raised: Insert the **drain plug** with the hole against the **drain tube** opening. When the **ball rod** is inserted in step 4, the rod will go through the hole in the drain plug.

To easily remove the plug after installation: Insert the **drain plug**. When the **ball rod** is inserted in step 4, the flat part of the **drain plug** will rest on the **ball rod** but the **ball rod** WILL NOT go through the hole in the **drain plug**.

4. INSTALL BALL ROD

Make sure the **rod seal** is positioned inside the **drain tube** opening. Remove the **clip** from the **ball rod**. Insert the **ball rod** through the opening in the drain tube until the ball meets the **rod seal**. It is installed correctly if the drain plug raises and lowers when the **ball rod** is moved up and down. Screw on the **ball rod nut**. Hand tighten only.

All plastic Assembly

1. DISASSEMBLE DRAIN FLANGE

Separate the **drain flange** and **drain flange seal** from the **drain tube**. Leave the **mounting nut, washer and compression washer** (beveled edge facing up) on the **drain tube**.

2. INSTALL DRAIN FLANGE & TUBE

NOTE: Tub & tile caulk can be applied to the underside of the **drain flange** in place of the **drain flange seal**. From under the sink, slide the **drain tube** through the drain hole in the sink. Screw the **drain flange** back onto the **drain tube** and position it in the sink. From under the sink slide the **compression washer** up against the sink. Slide the **flat washer** up to the **compression washer**. Screw on the **mounting nut** but **DO NOT TIGHTEN**. continue to step 3

5. REPOSITION DRAIN TUBE

Turn the **drain tube** so the **ball rod** is facing the back. Tighten the **mounting nut** on the **drain flange** until the **compression washer** is seated tightly against the sink.

6. INSTALL LOWER LIFT ROD

Loosen the **hex cap screw** on the **lower lift strap**. Raise the **ball rod** to its highest position. Determine the correct hole to use so the top of the **lower lift strap** does not touch the bottom of the sink. Slide one hole of the **clip** onto **ball rod**. Slide the **lower lift strap** onto the **ball rod** through the correct hole. Slide the other hole of the **clip** onto the **ball rod**.

7. INSERT UPPER LIFT ROD

Lower the **ball rod** to the lowest position. Thread the **upper lift rod** through the hole on the top of the faucet and the holes on the top of the **lower lift strap**. Tighten **thumb screw**.

8. CHECK INSTALLATION

Check all connections to make sure they're tight. Check operation of pop-up assembly. Adjust as needed for smooth operation.

METAL/PLASTIC COMBINATION UNIT

1. DISASSEMBLE DRAIN FLANGE

Separate the **drain flange** from the **drain tube**. Remove the **mounting nut, flat washer and compression washer**. Leave the **flange seal** in place.

2. INSTALL DRAIN FLANGE & TUBE

NOTE: Tub & tile caulk can be applied to the underside of the **drain flange** in place of the **drain flange seal**. Insert the **drain flange** and **seal** through the drain hole in the sink. From the underside of the sink and while holding the **drain flange** in place from above, push the **compression washer** with the beveled edge facing up, over the threads of the **drain flange** and up to the sink. Slide the **flat washer** up to the **compression washer**. Screw on the **mounting nut** but **DO NOT TIGHTEN**. Position the **drain tube seal** inside the **drain tube** and screw the **drain tube** onto the **drain flange**. Hand tighten. continue to step 3

Phoenix Products, Inc.
583 Miller Rd.
Avon Lake, OH 44012
©Phoenix Products, Inc. All rights reserved 2006

1.800.222.6041 Toll free
1.440.933.6252 Fax
www.phoenixfaucets.com